

Johnsonite®

LUMINOUS EGRESS
PATH SYSTEM

SAFE-T-FIRST®



THE ULTIMATE
FLOORING EXPERIENCE

What is Safe-T-First®?

Safe-T-First (STF) utilizes photoluminescent technology to provide a complete system for luminous egress path (exitway) markings, which is UL1994-listed, and in compliance with the International Building Code (IBC). The STF system delineates the escape route through emergency egress stairwells and hallways that may go dark in the event of a fire or other unexpected power outage. Particularly at a low location, where smoke is less dense, STF outlines continuous pathway elements to facilitate orientation and minimize panic during times of sudden darkness. As proven in a study conducted by the US National Institute of Standards and Technology, the speed of evacuation in a dark stairwell with photoluminescent markings was statistically equal to the speed of evacuation in a standard lighted stairwell.

What is Photoluminescence?

Photoluminescence is a phenomenon caused by non-toxic, inorganic, strontium aluminate crystals absorbing light source energy. During a fire or other unexpected power outage, the stored energy is released in the form of a yellow-green light. The current revision of the IBC requires that all buildings over 75 feet in height shall provide approved luminous egress path markings within interior exit stairways, ramps and passageways.





Carpet Cove Cap



Hand Rail Cover

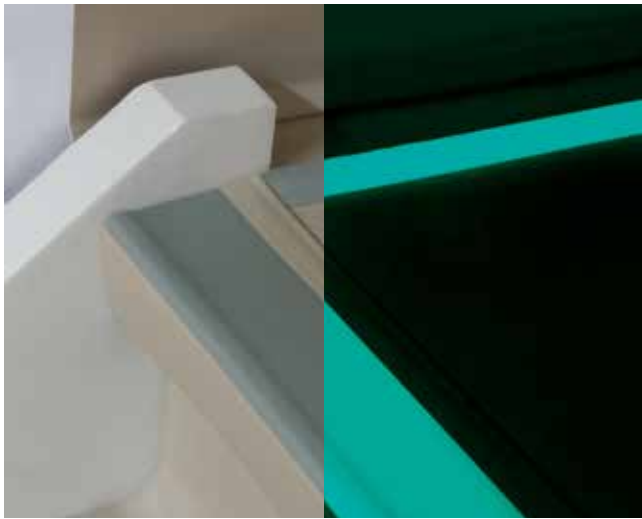

1" Feature Strip | Stair Nosing



Corner Bumper Guard | Wall Base



Feature Strip



Tactile Warning Strip





Johnsonite Safe-T-First® System

STF integrates photoluminescent technology into color- and design-coordinated resilient flooring products, allowing the space to look well-designed, in addition to providing safe passage. Available in 36 palette A ColorMatch® colors that coordinate through all Johnsonite flooring solutions, STF features low maintenance, highly durable surface finishes that diminish the use of water, chemicals and energy. The system's long life cycle and low maintenance requirements combine industry-leading safety, durability and aesthetic features.

* Note: For the Safe-T-First products which have the "green" photoluminescent striping, there may be slight variations in the green color from batch to batch, due to the inherent variation in the natural photoluminescent mineral (non-toxic strontium aluminate).



Rubber Stair Treads



- PVIRH-XX-RD | Round Pattern - Square Nose
- PVIRH-XX-SQ | Square Pattern - Square Nose
- PVIRTR-XX-RD | Rubber Tread & Riser - Round Pattern - Square Nose
- PVIRTR-XX-SQ | Rubber Tread & Riser - Square Pattern - Square Nose
- PVIHTR-XX | Rubber Tread & Riser - Hammered Pattern - Square Nose

Vinyl Stair Treads

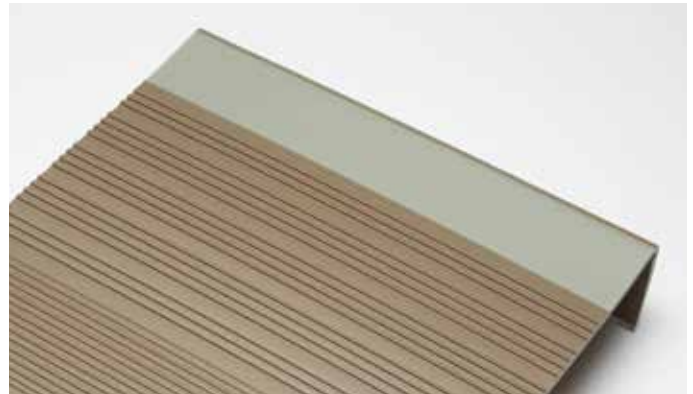

- PVIHDN-XX-SQ | Coextruded 2" Strip - Square Nose

Vinyl Stair Nosings



- PVITSNN-XX | Top Set Stair Nosing
- PVIRCNN-XX-A | Undercut Carpet
- PVIRCNN-XX-B | Heavy Duty Overlap Lip
- PVIRCN-XX-B2 | Heavy Duty Overlap Lip with 2" Tape
- PVIVCDN-XX | Double Undercut Nosing

Tactile Warning Strip

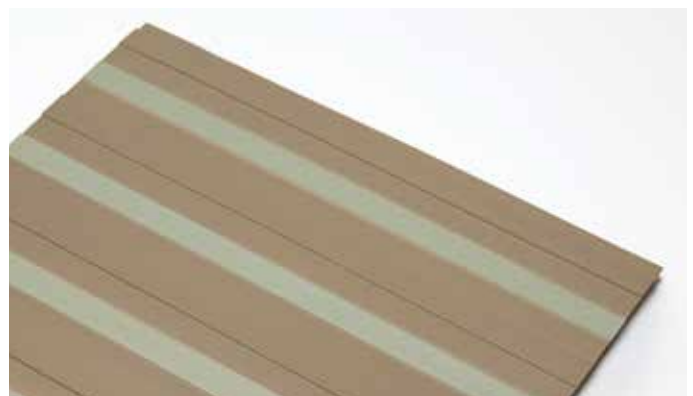

- PTWN-XX

Wall Base | 4", 6"



PDCN-XX-4"x4' | with 1" PL Strip PDCN-XX-6"x4' | with 1" PL Strip
PDCN-XX-4" x 120' | with 1" PL Strip PDCN-XX-6"x100' | with 1" PL Strip

Hand Rail Cover



PHCN-XX

Corner Guards



PVBGN-XX-D-4' | lengths
PVBGN-XX-D-8' | lengths

Cove Caps | Carpet & Resilient



PCCCN-99-C | 1/4" Carpet
PSCCN-99-B | 1/8" Resilient

Feature Strip & Guidance Strip



PVFSN-99-1" | 1" Feature Strip
PVGSN-99-1" | 1" Guidance Strip

Signage



P43867F | Man Right Sign - Self-adhesive
P42945F | Man Left Sign - Self-adhesive
P60204 | Door Handle Backing Sticker - Self-adhesive

Tapes



P40708 | 1" Plain Tape
P44151 | 1" Warning Tape with Black Diagonal Stripe



Safe-T-First® Recommended Color Palette

These colors are a balanced palette of neutrals, which work well with the green cast of the extruded photoluminescent striping, as well as the traditional yellow tape. This carefully selected palette balances superior performance with superior looks.



55 Silver Grey **WG**



32 Pebble **WG**



48 Grey **WG ****



20 Charcoal **WG ****



44 Dark Brown **B ****

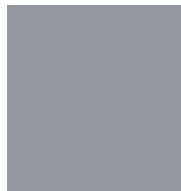

38 Pewter **CG**



28 Medium Grey **CG**



71 Storm Cloud **CG ****



63 Burnt Umber **B ****



40 Black **B ****

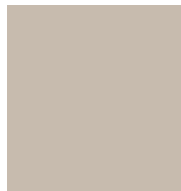

31 Zephyr **CB +**

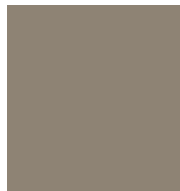

80 Fawn **CB**



283 Toast ******

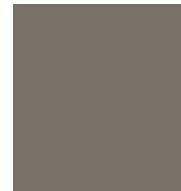

29 Moon Rock **WG ***



167 Fudge ******

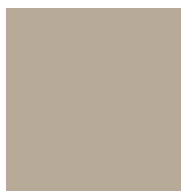

49 Beige **WB**



45 Sandalwood **WB ****



42 Sable **WB**



150 Wetlands *****



47 Brown ******



Other Standard Colors Available with Safe-T-First®

The remaining palette A ColorMatch® colors are also available as standard colors, in Safe-T-First.

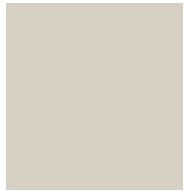

22 Pearl **CB** +

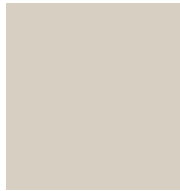

24 Grey Haze **WG** +

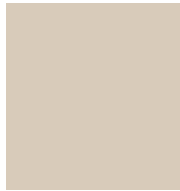

11 Canvas **WB** +

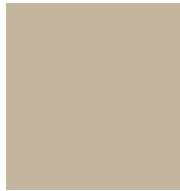

09 Clay **WB**

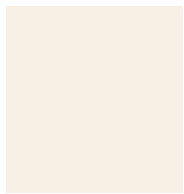

01 Snow White **W** +

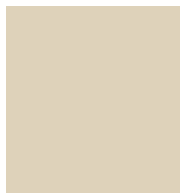

34 Almond **W** +

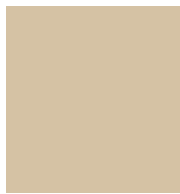

129 Silk **WB** +

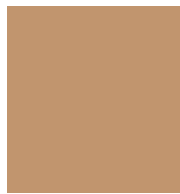

130 Sisal

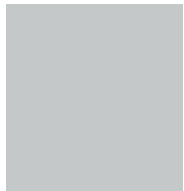

21 Platinum **CG** +

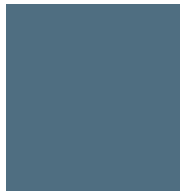

58 Windsor Blue ******



92 Blue Lagoon ******



18 Navy Blue ******



132 Espresso ******

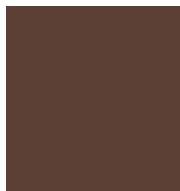

76 Cinnamon ******



85 Burgundy ******



86 Hunter Green ******



* These colors can be used in Safe-T-First Rubber Treads for Visually Impaired (VI) installations.

+ These colors can be used in Safe-T-First Vinyl Treads & Nosings for Visually Impaired (VI) installations.

We've identified Color Foundations™ neutrals in the following way:
WB (warm beige), **CB** (cool beige), **WG** (warm grey), **CG** (cool grey), **B** (black), **W** (white)

All colors shown in this card, including chips and photographs, approximate the actual flooring colors as accurately as possible.

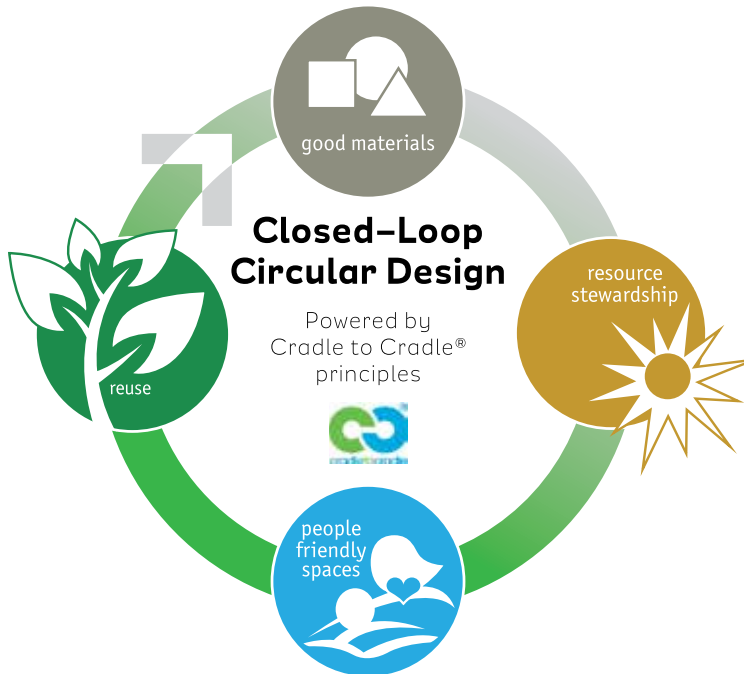
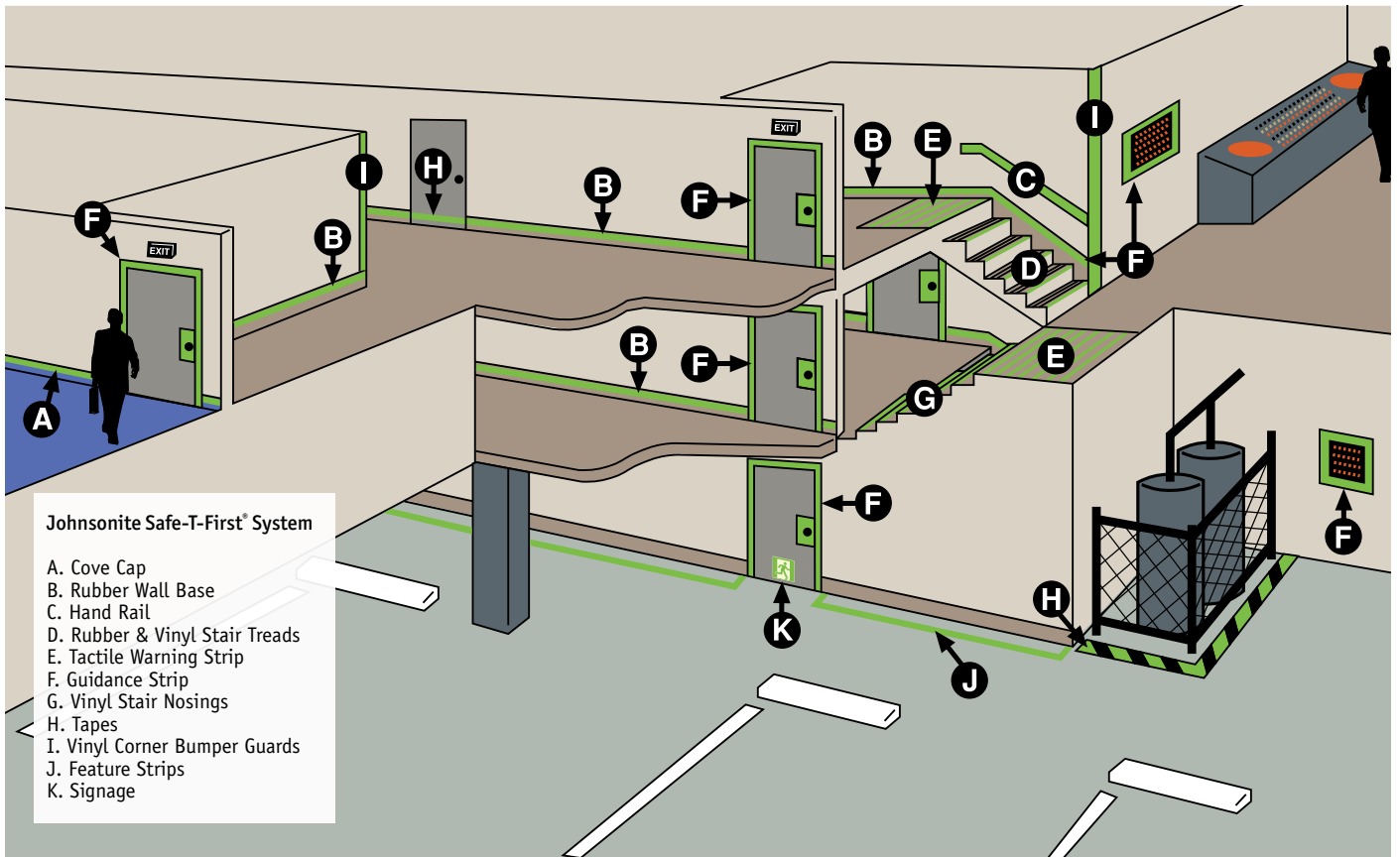

Safe-T-First is developed under the practice of Balanced Choice, meeting sustainability objectives through better raw materials, resource stewardship, developing people friendly spaces and recycling/reusing.

For additional samples or information on Johnsonite's full line of flooring and finishing accessories, please visit www.tarkettna.com or contact the sample department at 800.899.8916.